

ASSEMBLY INSTRUCTIONS

SHIM KIT FOR ELITE SERIES

FIFTH WHEEL HITCH

DEALER/INSTALLER:

- (1) Provide this Manual to end user.
- (2) Physically demonstrate procedures in this Manual to end user.
- (3) Have end user demonstrate that he/she understands procedures.

END USER:

- (1) Read and follow this Manual every time you use Hitch.
- (2) Save this Manual for future reference.
- (3) Pass on copies of Manual to any other user or owner of Hitch.

| Item | Description | QTY |
|------|-----------------------|-----|
| 1 | Shim | 2 |
| 2 | Socket head cap screw | 2 |
| 3 | Flat washers | 2 |
| 4 | Nylock Hex nut | 2 |

Tools required:

3/16" Allen wrench

5/16" Drill bit

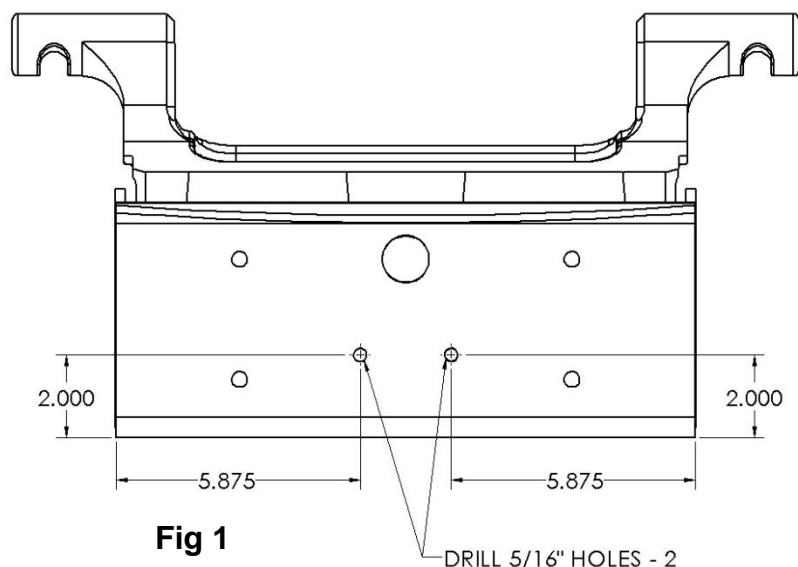

Fig 1

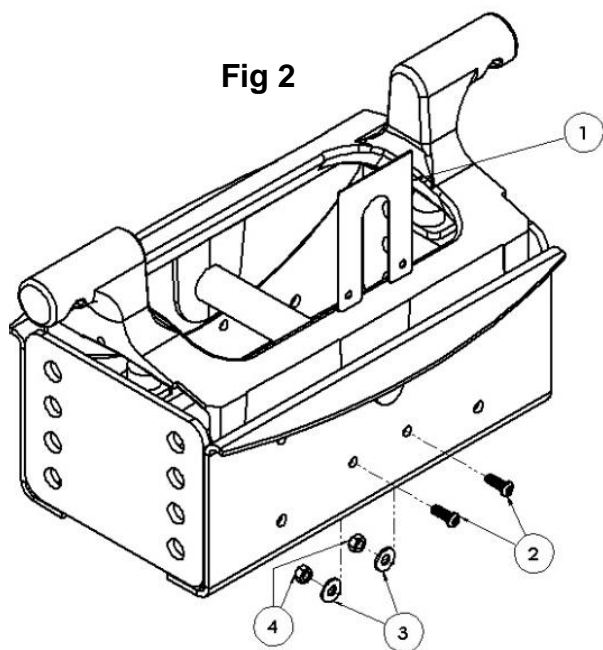

Fig 2

Installation instructions:

1. Mark the two locations for the 5/16" holes as shown in Figure 1
2. Drill both locations
3. Slide one shim (1) between the pivot beam and inner side of center box as shown in Fig 2
4. Put bolts (2) through holes and add washer (3) and lock nut (4) to inside of assembly and tighten
5. If a single shim is not enough, use the second shim with the first shim

For Installation Assistance or Technical Help, Call 1-888-521-0510